

# Online Installation Instructions

## Science Table v3.0.1



Follow these instructions to install the Science Table v3.0.1 software on your Anatomage Table. It is recommended to run the installer overnight and not use the Anatomage Table during the installation process.

For any general questions or installation error inquiries, please contact:

[sciencetable@anatomage.com](mailto:sciencetable@anatomage.com)

## Required Items

To install Science Table v3.0.1, confirm that you have the following items:

1. A stable internet connection.
2. An Authorization Code.

Note: You will need to request the code from anatomage. If you have not received your code, email: [sciencetable@anatomage.com](mailto:sciencetable@anatomage.com)

## Installation Instructions

1. To download Science Table v3.0.1, open a web browser on your Table and navigate to: [https://anatomagetable.com/Software/SoftwareScienceTableLogin.aspx?ReturnUrl=/Software/ScienceTable30\\_installer](https://anatomagetable.com/Software/SoftwareScienceTableLogin.aspx?ReturnUrl=/Software/ScienceTable30_installer)
2. The password to download the installer is: **sciencetablessoftware**  
*Please make sure there are no spaces when you type in the password. The password is the phrase "science table software" with the spaces removed.*  
Press "Enter" to proceed.
3. Download the installer for Science Table 3.0.1 by clicking the "Download Software" link. The ScienceTable\_3.0.1\_Installer.exe will appear in your downloads folder.



4. Open the ScienceTable\_3.0.1\_Installer.exe in your downloads folder. The installer setup window will appear. Press “Next >” to continue.

*Note: The Science Table 3.0.1 installer may update your computer drivers throughout the installation process and may require a computer restart after the installation has finished.*

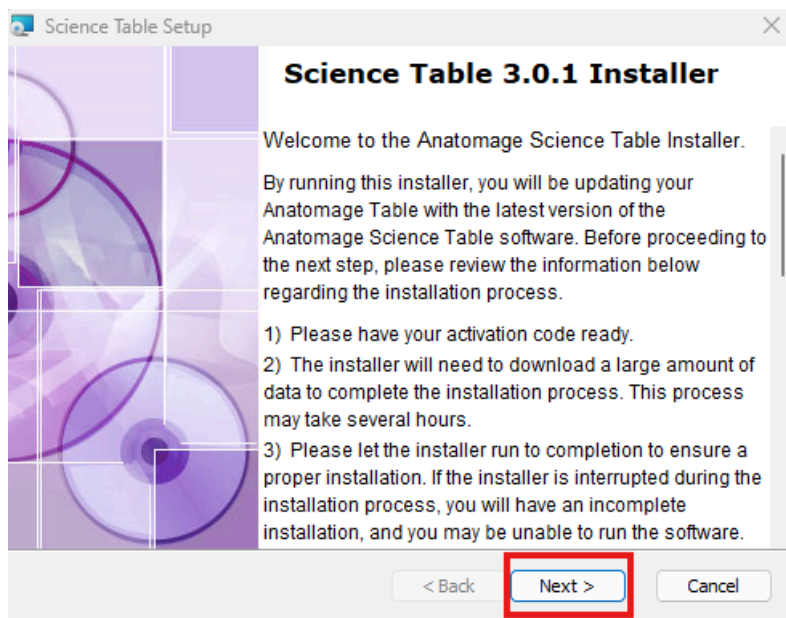

5. A “Software Activation” window will appear. Enter your authorization code and click the “Next >” button.

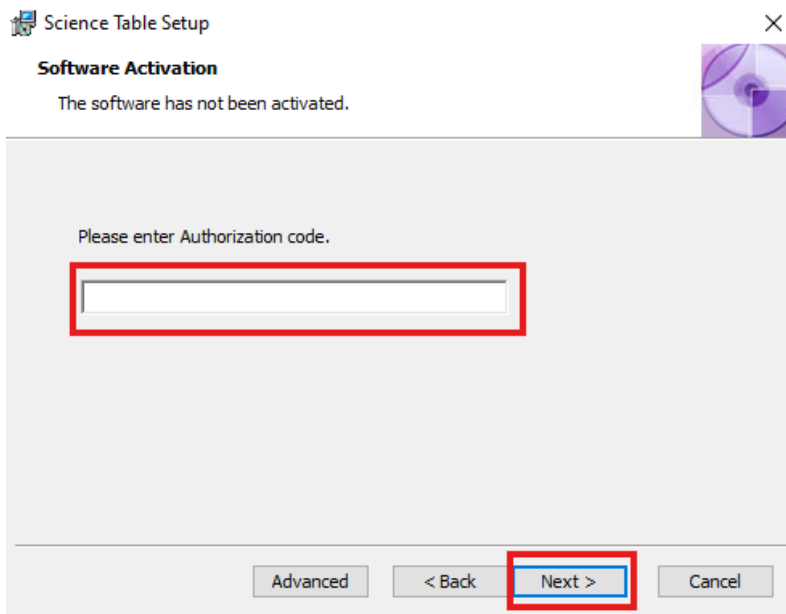

6. A “Select Installation Folder” window will appear. Most users can click “Next >” to advance to the next step.

*Note: If you'd like to change where you install the software, click “Browse” and select the folder using the Windows File Explorer.*

7. A “Ready to Install” window will appear. Confirm the installation by clicking “Install”. The installation will begin. **The installation process may take a few hours. Do not shut down the table while the installation is running.**

8. Once the installation is complete, a confirmation window will appear. Click “Finish” to complete the installation and close out the install window.

*Note: Your computer may have automatically restarted due to other drivers being updated. If your computer did restart, when you return to the table it may be at the Windows Login Screen and the confirmation window will not be visible.*

9. Verify that the installation is successful and Science Table 3.0.1 is working properly. **Double-click on the Science Table 3.0.1 desktop icon. This will open the Science Table 3.0.1 application.**

